

WIDECOMBE VILLAGE HALL

Preliminary Area Schedule

Feb 2018 Rev A



DAVID WILSON PARTNERSHIP

Connecting people and spaces

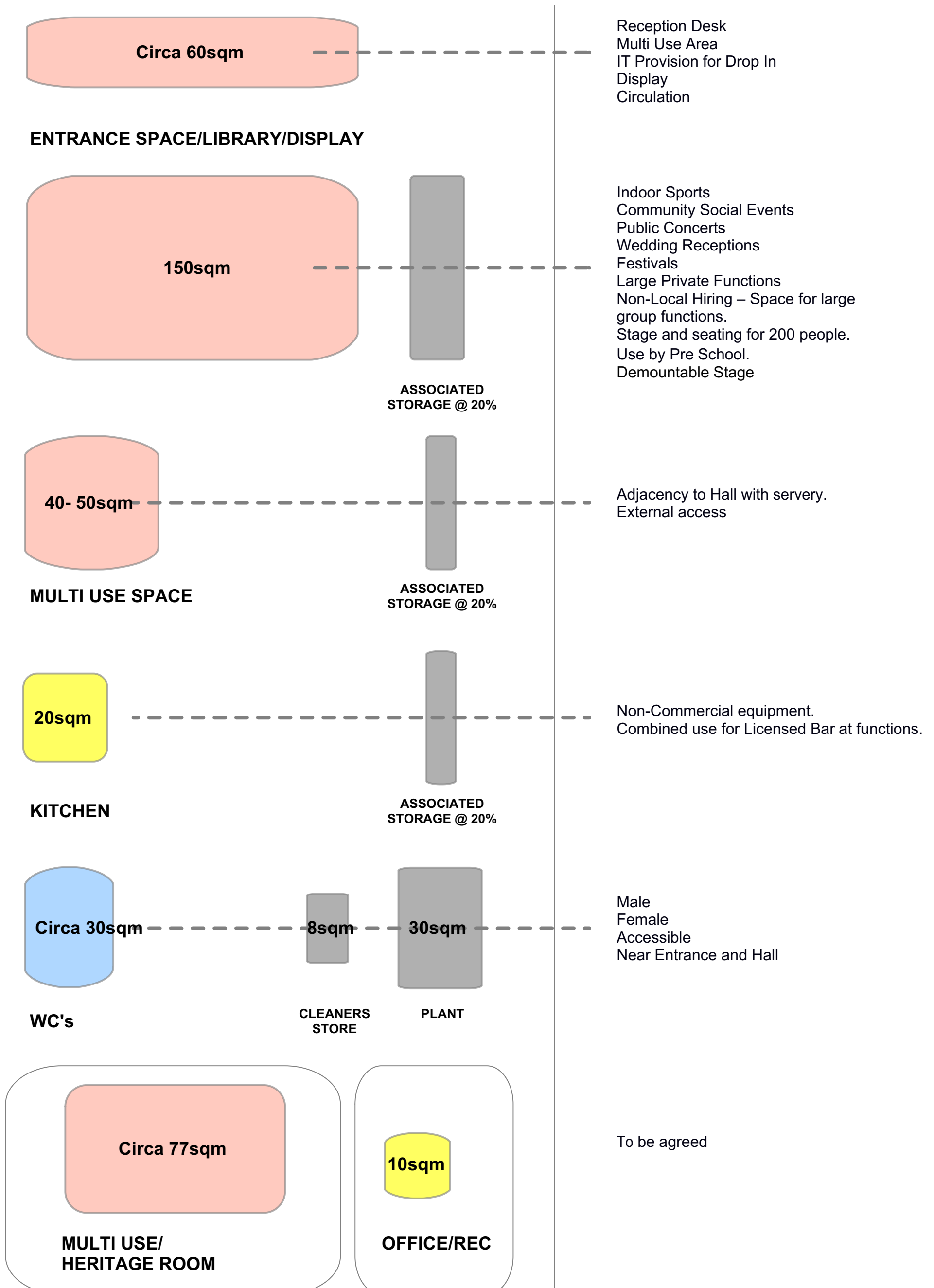

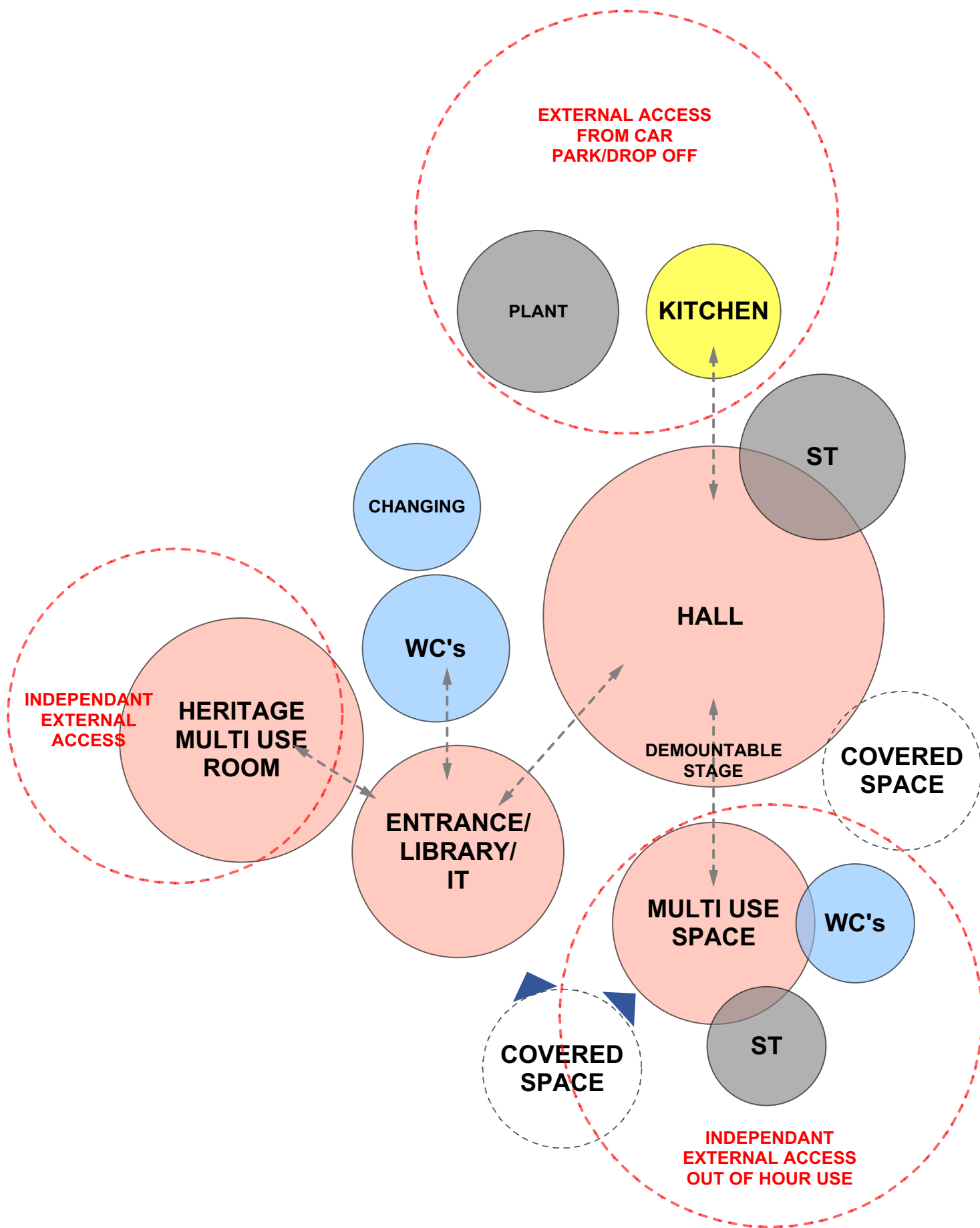

WIDECOMBE VILLAGE HALL

Preliminary Plan Diagram -

With Heritage Space

Feb 2018 Rev A



DAVID WILSON PARTNERSHIP

Connecting people and spaces

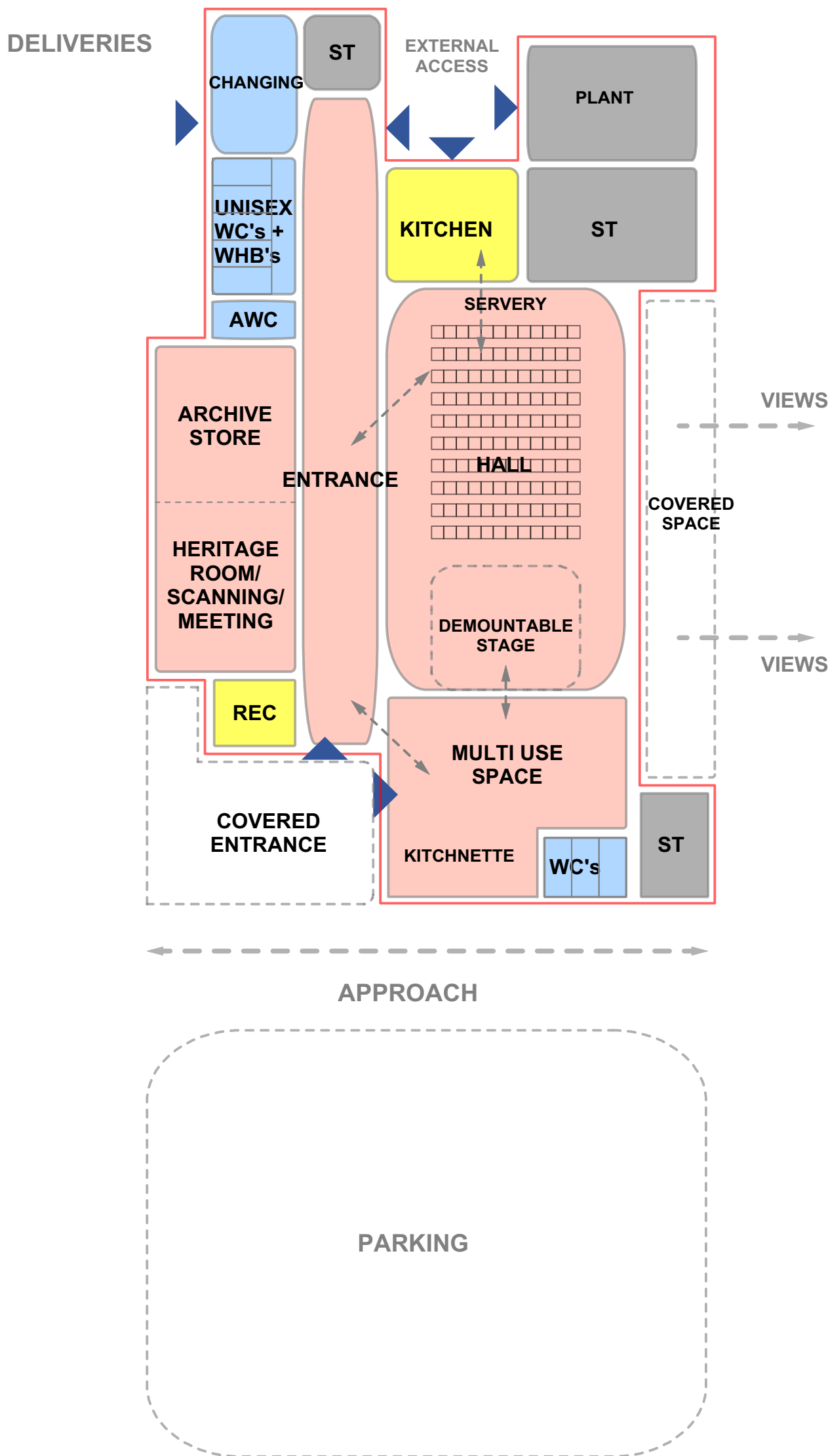

GIA Circa 630sqm

COMMENTARY

History Group requirements added - 13m x 6m area divided into 2 spaces including document storage room.

Potential for archive room to be shared with rec as drop in office/meeting space - to be reviewed with WVHSG + History Group.

Kitchen revised to 20sqm as confirmed by WVHSG. Commercial dishwasher but otherwise non commercial fit out.

Multi Use Space kitchenette to be worktop and kettle provision within room.

Separate wc's to MUS still shown this enables independant Pre School and Out of Hours use without opening up whole Centre. Flexibility of future use. Independant access to wc's without crossing into 'public space' usually required in pre school arrangements for safe guarding. Position also provides direct access to hall for Pre School and potential for opening up MUS to Hall for functions (folding wall) or use as Green Room.

Main Hall reduces to 120 seat capacity as Client request.

WC provision reviewed against BS 6465 see below. Individual WC rooms with whb shown. Area for Sport England 19sqm model changing room included. Positioned adjacent to other wc provision and service giving access to tennis courts.

Office Space omitted - potential to share Heritage Room work/meeting area.

Meeting Room/MUS relationships maintained as previously shown to enable Hall to be extended into MUS for large functions with direct servery access from kitchen to Hall. To be discussed at next Client Meeting.

WC PROVISION

Minimum provision of sanitary appliances for assembly buildings where toilet use is NOT concentrated during intervals. For example, exhibition centres, libraries, museums and similar buildings.

WC's Assumed Max Building
Occupancy: 160 50/50 M/F Split
Hall 120 + MUS 30 + History Space 10

1 per 250 males, plus 1 for every additional 500 males or part thereof
Male WC provision should be half female WC provision where urinals are not used

2 for up to 40 females;
3 for up to 70 females;
4 for up to 100 females;
plus 1 for every additional 50 females or part thereof
Urinal
1 per 50 males up to 100 males; plus 1 for every additional 100 males or part thereof
N/A
Washbasin
1 per WC and in addition, 1 per 5 urinals or part thereof
1, plus 1 per 2 WCs or part thereof

WIDECOMBE VILLAGE HALL

Preliminary Plan Diagram -

Without Heritage Space

Feb 2018



DAVID WILSON PARTNERSHIP

Connecting people and spaces

DELIVERIES

EXTERNAL ACCESS

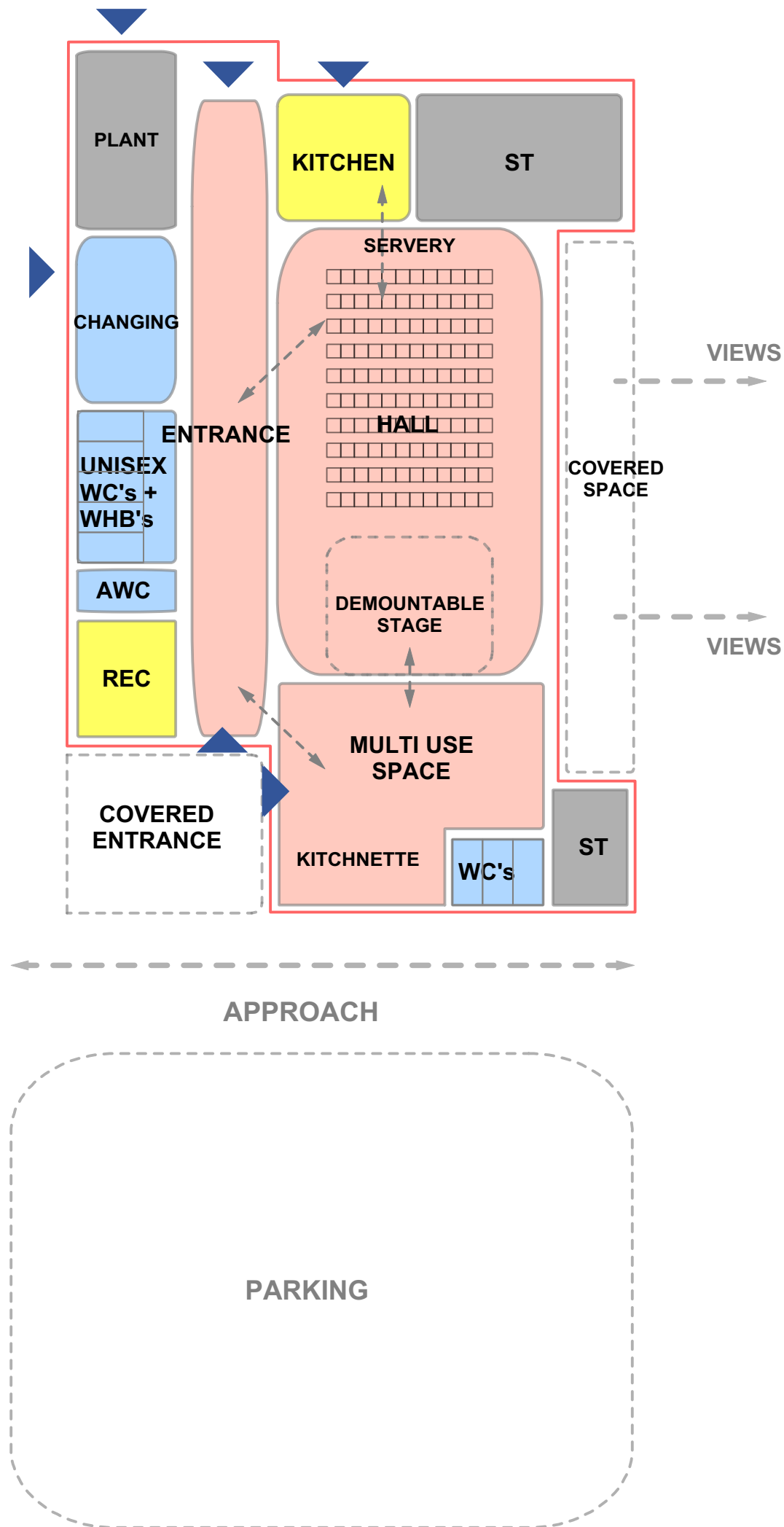

GIA Circa 550sqm

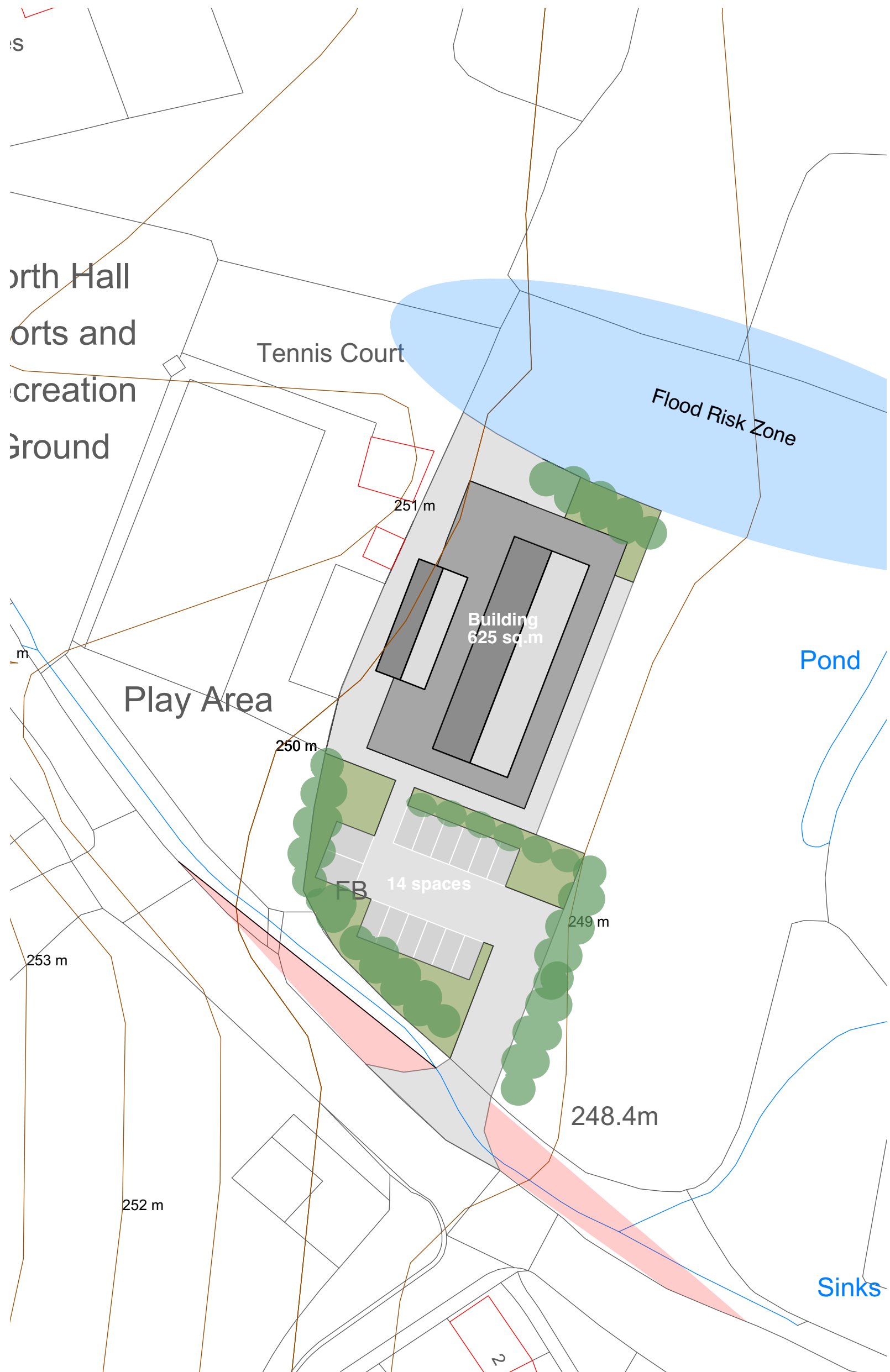

WIDECOMBE VILLAGE HALL

Preliminary Site Plan -

Feb 2018



DAVID WILSON PARTNERSHIP

Connecting people and spaces

